

Table Mount C-Clamps & Expand-O Pliers

The only expanding and spreading pliers in the market.

Table Mount Locking C-Clamps



PTT934

- » Mounts directly to any work bench, drill press, etc.
- » Mounting base hole accepts standard 5/16"-18 bolts and uses push-down action to hold your workpiece securely.
- » Use the L-Handle for rapid tightening
- » Rapid lock and release. Ideal for repetitious clamping.

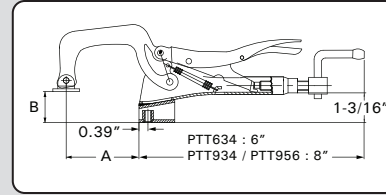

Part No.	Throat Depth (A)	Max. Capacity (B)	Mount Thread	Weight
PTT634 PT09	3" 76 mm	4" 102 mm	5/16-18 M8	0.9 lbs 0.4 kg
PTT934 PT11	3-3/8" 86 mm	4" 102 mm	5/16-18 M8	1.6 lbs 0.7 kg
PTT956 PT14	6-1/8" 155 mm	4-3/4" 120 mm	5/16-18 M8	2.0 lbs 0.9 kg

Expand-O Pliers

Unique, Reverse-Action Clamping Pliers!

Jaws move in opposite directions to push against two surfaces.

Patent No. US 6,993,999 B2

Ideal for Metal or Wood working.

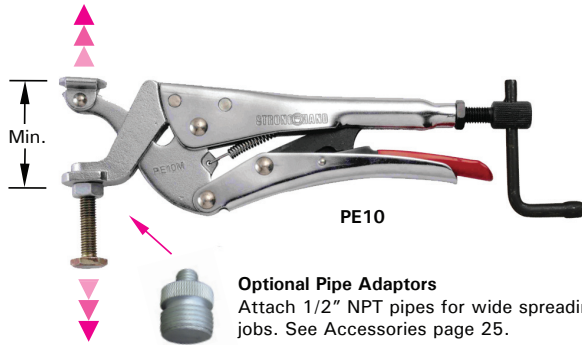

PE10

Optional Pipe Adaptors
Attach 1/2" NPT pipes for wide spreading jobs. See Accessories page 25.

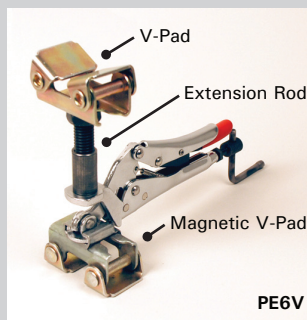
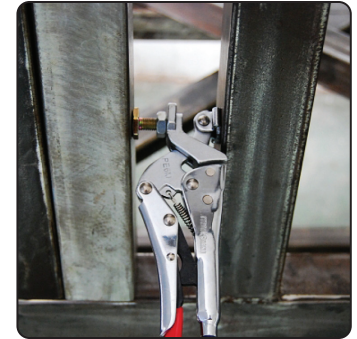
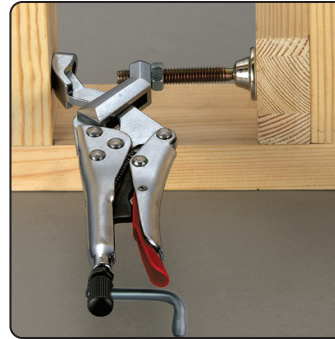

PE6V

NEW! Expand-O Pliers with V-Pads and Extension Rod! (PEV6 & PEV10)

Features:

- » One Magnetic V-Pad, One Standard V-Pad.
- » Use the Extension Rod to increase reach by 1" - 2".
- » Use the bottom Adjustable Magnetic V-Pad to set the pliers in place.
- » When expanding, the two V-pads instantly adjust to round or flat surfaces.

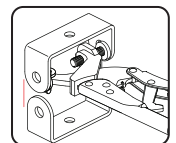
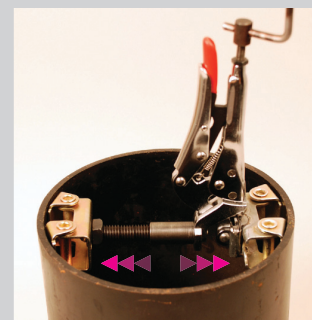

Expand brackets

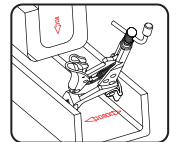

Insert panel into U-channel

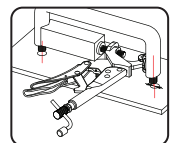

Align to fit holes

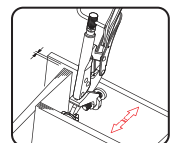

Separate cabinets

Part No.	OAL	Clamping Pressure	Thread	Min.	Stroke	Weight
PE6 PE6M	6-1/2" 165 mm	500 lbs 230 kg	5/16-18 M8	1" 25 mm	3/4" 19 mm	0.5 lbs 0.2 kg
PE10 PE10M	10" 255 mm	900 lbs 410 kg	3/8-16 M10	1-3/8" 35 mm	1-3/8" 35 mm	1.8 lbs 0.8 kg
PEV6	6-1/2" 165 mm	500 lbs 230 kg	5/16-18 M8	1" 25 mm	3/4" 19 mm	0.8 lbs 0.4 kg
PEV10	10" 255 mm	900 lbs 410 kg	3/8-16 M10	1-3/8" 35 mm	1-3/8" 35 mm	2.4 lbs 1.1 kg